

**The Essex County Council (B1010 Maldon Road & B1021 Southminster Road,
Burnham on Crouch) (30MPH & 40MPH Speed Limit) Order 2024**

The Essex County Council (hereinafter referred to as "the Council") in exercise of its powers under S84(1) and (2) of the Road Traffic Regulation Act 1984 (as amended) (hereinafter referred to as "the Act") and of all other enabling powers and after consultation with the Chief Officer of Police in accordance with Part III of Schedule 9 of the Act, hereby make the following Order: -

1. No person shall cause any motor vehicle to proceed at a speed exceeding 30 miles per hour on those lengths of roads, Burnham on Crouch in the District of Maldon as specified in Schedule 1 to this order.
2. No person shall cause any motor vehicle to proceed at a speed exceeding 40 miles per hour on those lengths of roads, Burnham on Crouch in the District of Maldon as specified in Schedule 2 to this order.
3. No speed restriction imposed by this Order applies to vehicles falling within regulation 3(4) of the Road Traffic Exemptions (Special Forces) (Variation and Amendment) Regulations 2011 when used in accordance with regulation 3(5) of those Regulations.
4. The Essex County Council (Burnham on Crouch) (Restricted Roads) Order 2011 is hereby revoked in its entirety. All restrictions shall continue in force by virtue of this order.
5. This Order shall come into operation on 22 April 2024 and may be cited as The Essex County Council (B1010 Maldon Road & B1021 Southminster Road, Burnham on Crouch) (30MPH & 40MPH Speed Limit) Order 2024.

Sealed with the Common Seal of the Essex County Council this 10th Day of April Two Thousand and Twenty-Four.

THE COMMON SEAL of the ESSEX)
COUNTY COUNCIL was hereunto)
Affixed in the presence of: -)

[Handwritten Signature]
L. A. JENKINS



Schedule 1 – 30MPH Speed Limit

Road	Description
B1010 Maldon Road	From its junction with King Edward Avenue, northwest for approximately 1458.5 metres.
B1021 Southminster Road	From a point level with the southern kerb line of Barnmead Way, north to a point level with the southern kerb line of Cobbins Chase, approximately 176 metres.

Schedule 2 – 40MPH Speed Limit

Road	Description
B1021 Southminster Road	From a point in line with the southern kerb line of Cobbins Chase, in a northerly direction for approximately 560 metres.

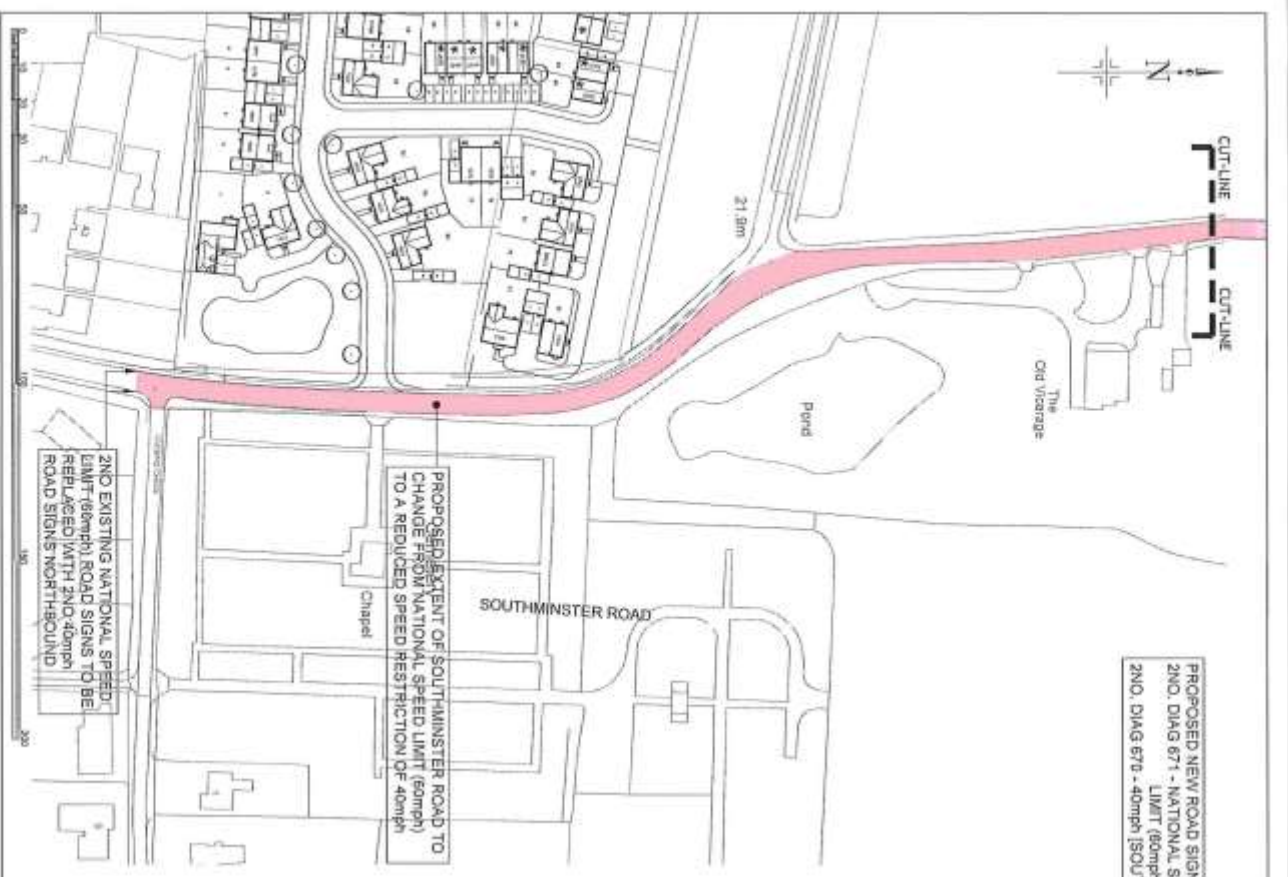

PROPOSED NEW ROAD SIGNS:
 2NO. DIAG 671 - NATIONAL SPEED LIMIT (60mph) (NORTHBOUND)
 2NO. DIAG 670 - 40mph (SOUTHBOUND)

PROPOSED EXTENT OF SOUTHMINSTER ROAD TO CHANGE FROM NATIONAL SPEED LIMIT (60mph) TO A REDUCED SPEED RESTRICTION OF 40mph

2NO. EXISTING NATIONAL SPEED LIMIT (60mph) ROAD SIGNS TO BE REPLACED WITH 2NO. 40mph ROAD SIGNS NORTHBOUND

- NOTES**
1. CONTRACTORS MUST CHECK ALL DIMENSIONS ON SITE. ONLY FIGURED DIMENSIONS ARE TO BE WORKED FROM. DISCREPANCIES MUST BE REPORTED TO THE ARCHITECT OR ENGINEER BEFORE PROCEEDING. © THIS DRAWING IS COPYRIGHT.
 2. REPRODUCED FROM OS SITEMAP © BY PERMISSION OF ORDNANCE SURVEY © ON BEHALF OF THE CONTROLLER OF HER MAJESTY'S STATIONERY OFFICE. © CROWN COPYRIGHT 2008. ALL RIGHTS RESERVED. LICENCE NUMBER 100007128.
 3. UNTIL TECHNICAL APPROVAL HAS BEEN OBTAINED FROM THE RELEVANT AUTHORITIES, ALL DRAWINGS ARE ISSUED AS PRELIMINARY AND NOT FOR CONSTRUCTION. SHOULD THE CONTRACTOR COMMENCE SITE WORK PRIOR TO APPROVAL BEING GIVEN IT IS ENTIRELY AT THEIR OWN RISK.
 4. WOODS HARDWICK CANNOT ACCEPT LIABILITY FOR ANY DISCREPANCIES IN TERMS OF COORDINATES OR ANY OTHER INFORMATION DERIVED FROM DWGS.

THERE ARE NO EXCEPTIONAL RISKS ASSOCIATED WITH THESE WORKS. REFER TO THE DESIGNERS RISK ASSESSMENT FOR THE FULL ASSESSMENT OF RISKS.

SAFETY HEALTH AND ENVIRONMENTAL

REVISION	DESCRIPTION	DATE
C	SPEED SIGNS RELOCATED NORTH.	07.02.22
B	TITLE BLOCK REVISED. ROAD NAME ADDED.	27.02.20
A	SPEED REDUCTION ALTERED TO 40mph IN ACCORDANCE WITH RWGWAY COMMENTS DATED 12.02.19	26.03.19

PRELIMINARY
 INFORMATION
 TENDER
 CONSTRUCTION
 DRAWN
 CHECKED
 AS BUILT
 DATE

WOODS HARDWICK
 ARCHITECTS, ENGINEERS AND DEVELOPMENT CONSULTANTS

16-17 3RD FLOOR, 100 BROADWAY
 100 BROADWAY, 10TH FLOOR, NEW YORK, NY 10004
 TEL: +1 212 512 2000
 FAX: +1 212 512 2001
 WWW.WOODSHARDWICK.COM

TITLE: SOUTHMINSTER ROAD
 BURNHAM-ON-CROUCH
 DETAILS PROPOSED TPO PLAN

SCALE: 1:1250 @ A3 DATE: DECEMBER 2018 DRAWN: CA CHK: PK
 Please consider the environment before printing this drawing
 Paper: Filing: 18053-0-Chairings

18053-SOUT-5-300-C